

Tracoe Kids Silcosoft – REF 370

Tracheostomy tube for children, made from silicone

Product Description

True greatness sometimes shows itself in small things. There are two tracheostomy tube product lines in our kids product group: the tried and trusted Tracoe Mini and the silicone tubes Tracoe Silcosoft. The tracheostomy tubes in both these lines have been developed especially for neonates, infants and children. We have focused particularly on the flange design and the use of comfortable materials.



Scope of Supply

- Ring obturator
- Neck strap
- Disconnection wedge

General Information	
Product line	Silcosoft
Legal manufacturer	Tracoe Medical GmbH Reichelsheimer Str. 1/3 55268 Nieder-Olm, Germany
Country of origin	Germany
Colour Coding	
Handling	
Shelf life	5 years, from date of production
Maximum Useful Life	29 days, from first use

Material Specifications	
Material Cannula/Wire Coil	Silicone/Nitinol
Material Neck Flange	Silicone
Material Cuff	n/a
Biocompatibility	EN ISO 10993-1
Storage	

Packaging	
Packaging unit	1 piece
Weight	See Table
Dimensions (W x H x L)	100 x 154 x 52 mm
Material outer packaging:	Cardboard box
Material sterile packaging:	PET blister with medical paper

Certification	
Product classification acc. MDR	IIb
CE Marking	
GMDN	35404
Quality system certified to	EN ISO 13485
FDA registration	Clearance Number K172720

Product Range

Size	Order Number	ID	OD	A	C	TL	OB	BA	Gross Weight	Global Trade Item Number
		mm	mm	mm	mm	mm	mm	°	g	
2.5	REF 370-2.5	2,5	4,4	9	29	38	40	120	147	04035324028290
3.0	REF 370-3.0	3,0	4,9	10	29	39	41	120	165	04035324028306
3.5	REF 370-3.5	3,5	5,4	11	29	40	43	120	148	04035324028320
4.0	REF 370-4.0	4,0	6,0	12	29	41	44	120	148	04035324028337
4.5	REF 370-4.5	4,5	6,6	13	29	42	45	120	152	04035324028344
5.0	REF 370-5.0	5,0	7,3	15	29	44	48	120	149	04035324028351
5.5	REF 370-5.5	5,5	8,4	17	29	46	50	120	149	04035324028368

Legend

- ID-IC** Inside diameter at bottom of inner cannula
- OD-OC bc** Outside diameter at bottom of outer cannula
- OD-OC bf** Outside diameter of outer cannula behind the flange
- TL** Length along centre line from start of neck flange to bottom of tube
- OB** Length along outer bend from start of neck flange to bottom of tube
- BA** Bending angle
- CD** Cuff diameter

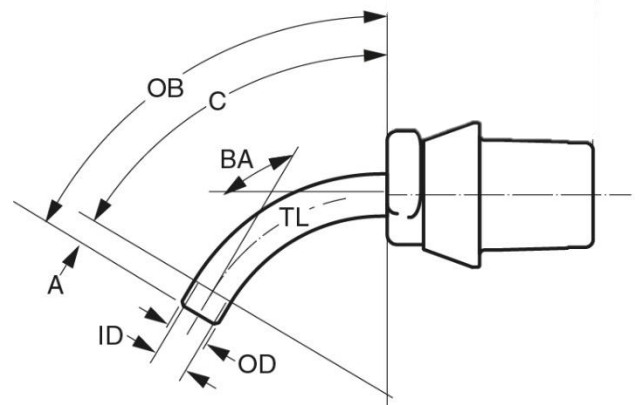

Tracoe Medical GmbH
Reichelsheimer Str. 1 / 3
55268 Nieder-Olm
Germany



Breathing-Speaking-Living

Atos Medical AB
Hyllie Boulevard 17
215 32 Malmö
Sweden
www.atosmedical.com